

# User Manual

English

## 1450 Coin Counter & Sorter

## Safety precautions

---

- Do not use flammable spray to clean the machine.
- If the machine is exposed to cold environment for a long time, it is necessary to sustain it at room temperature about two hours before use.
- Please ensure that no foreign objects (e.g. no coins other than euro coins, paper clips, staples, paper of coin tubes) fall into the machine, these may block the mechanical parts and the sensors of the machine and damage or break them.
- On the edge of the hopper, there is a warning line (“FULL LINE”), the coins in the hopper should not exceed this line, otherwise it will affect the performance of the machine.
- If the unit makes unusual noise or gets stuck while the counting process is running, switch off the machine and check whether foreign objects are inside the unit.
- Always stop and power-off the machine before cleaning or maintenance, to prevent injuries.
- Do not remove the cover of the machine unless the machine is unplugged from the power outlet.
- To prevent shock hazard, do not touch the power cable with wet hands.
- To prevent fire or short circuit, unplug the unit if you want to move it to another position.
- Hold the plug disconnecting the unit from the power outlet, never pull the cord.

## Introduction

---

Thank you for purchasing the Safescan 1450 coin counter and sorter. For proper use and maintenance, we advise to read this user manual carefully.

### Please note

---

Should the equipment be altered in any way or used in a manner for which it was not intended at the time of delivery, the supplier of the equipment accepts no responsibility for injury or damage to personnel or equipment.

## Package contents

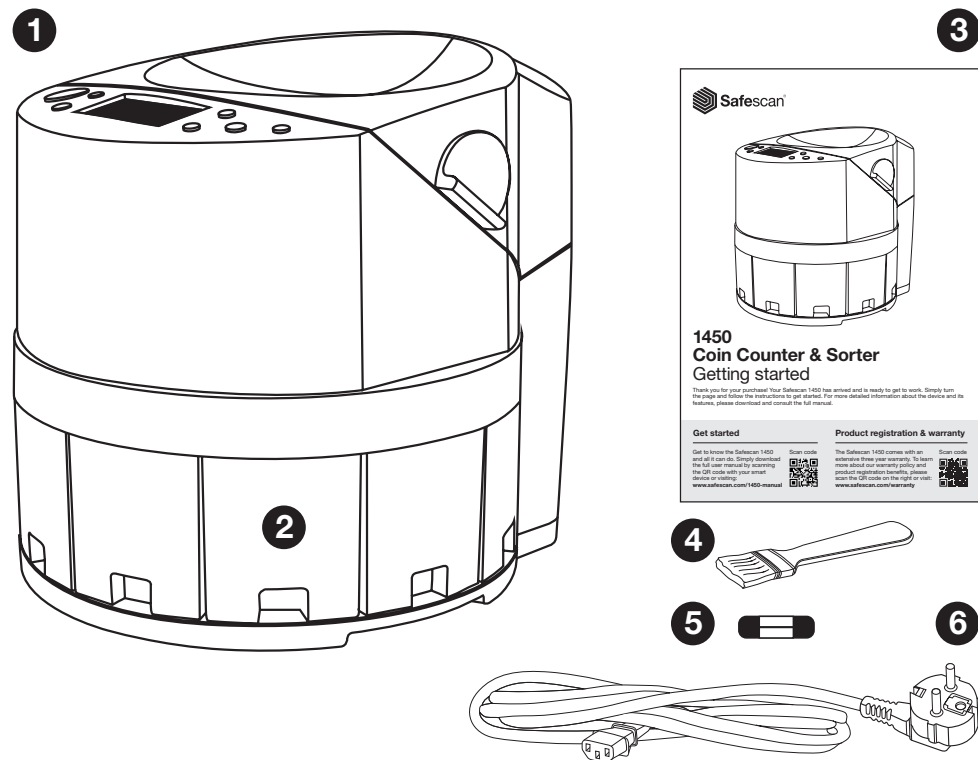

1. Safescan 1450 Coin Counter
2. Set of 8 coin cups
3. Get Started folder
4. Cleaning brush
5. Spare fuse
6. Power cord

## Machine parts

### Front

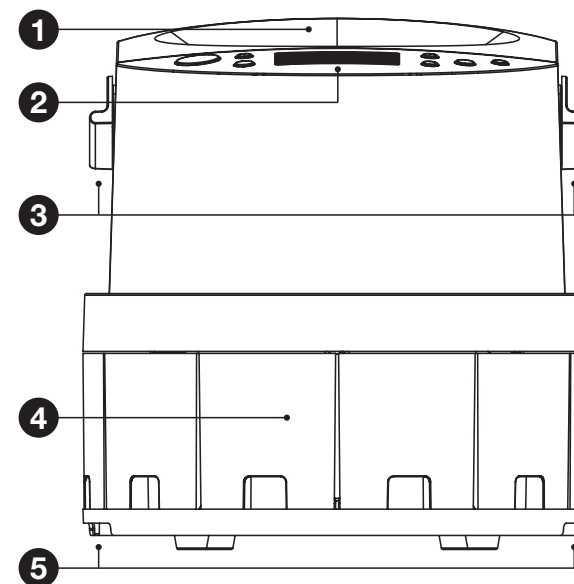

1. Coin hopper
2. Control panel & LCD display
3. Coin hopper release handles (not for lifting the machine!)
4. Coin cups
5. Grip area to lift the machine

### Back

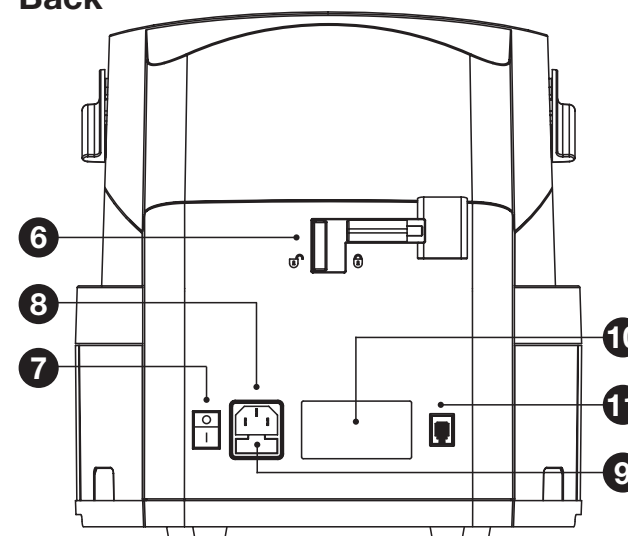

6. Safety lock
7. Power switch
8. Mains power connector
9. Fuse
10. Product label
11. Print port connector (RJ-10)

## Setting up your machine

1. Connect the power cord to the power connector at the back of the 1450.  
Connect the power cord into the mains outlet (AC 220~240V).
2. Switch on the counter with the power switch located at the back.
3. The counter performs a self-test. The display will show the firmware version.
4. When display shows 0 pcs / 0.00 the device is ready for counting coins.

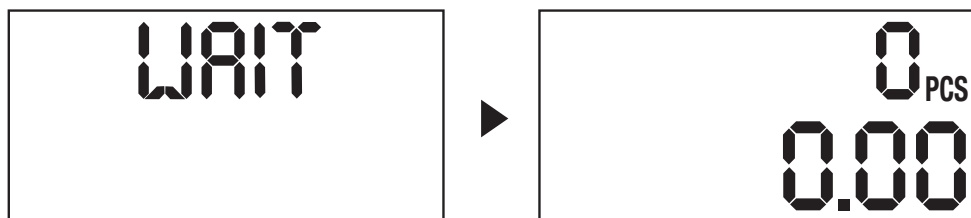

## Control panel



Nr	Button	Count menu	Settings mode	Report menu
1.	[START]	Start/Stop counting	Exit settings menu	Exit report menu
2.	[SETTINGS]	Open settings menu	Toggle between Batch settings and Time & Date settings	Open settings menu
3.	[REPORT]	Open report menu	Open report menu	Toggle between count result per denomination starting with € 0.01
4.	[+]	Activate/ Deactivate batch counting	Press once: Increase value with 1. Press and hold: Increase value in steps of 10	n.a.
5.	[-]	n.a.	Decrease value with 1. Press and hold: decrease value in steps of 10	n.a.

Nr	Button	Count menu	Settings mode	Report menu
6.	[CLEAR]	Clear count result	Clear batch settings entry	Clear count results
7.	[PRINT/>]	Print count results	Batch settings: Toggle between the denominations. Toggle between Time & Date settings	Print count results

## Display overview

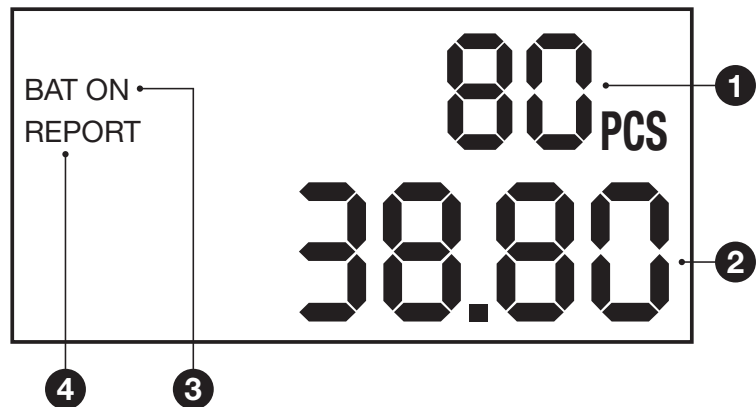

1. Total number of coins counted
2. Total value of coins counted
3. Batch function is activated
4. Report function is activated

## First operation

### Please note

The 1450 counts Euro coins only. Ensure that no foreign objects or coins of other currencies enter the machine - this will cause the machine to malfunction.

1. Put the coins in the hopper. ⚠ Do not exceed the 'full line' as indicated inside the hopper.

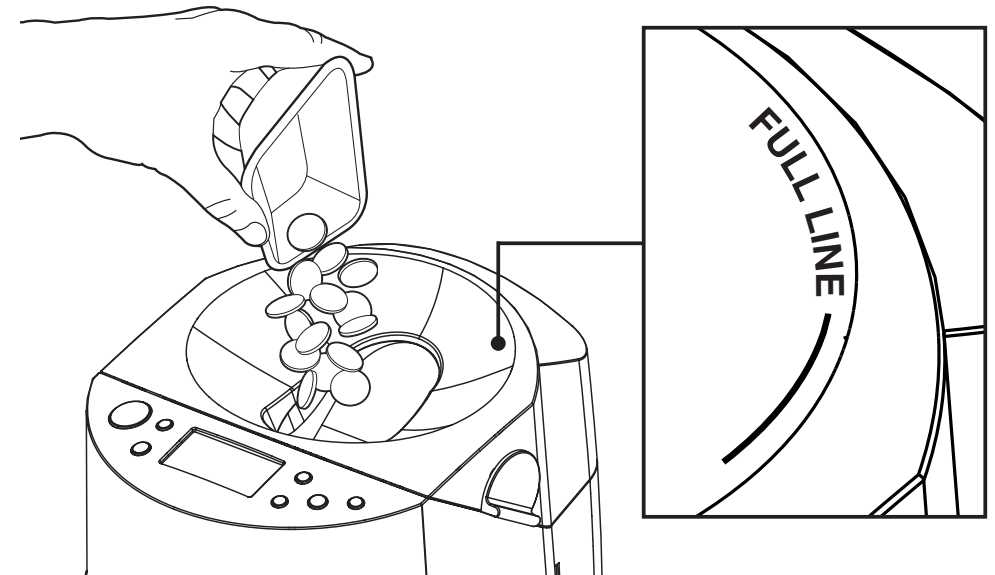

2. Press [START] to start the counting and sorting process. Continue to pour the coins in small quantities into the hopper.

3. After all coins have been counted and sorted, the counter automatically stops. The count result (total number of coins and the total value) is shown on the LCD display.

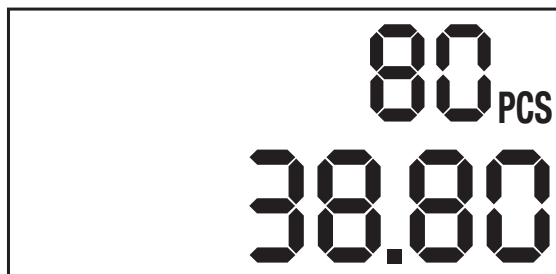

4. The coins are sorted on diameter, from large (left) to small (right).  
€ 2 - € 0.50 - € 1 - € 0.20 - € 0.05 - € 0.10 - € 0.02 - € 0.01

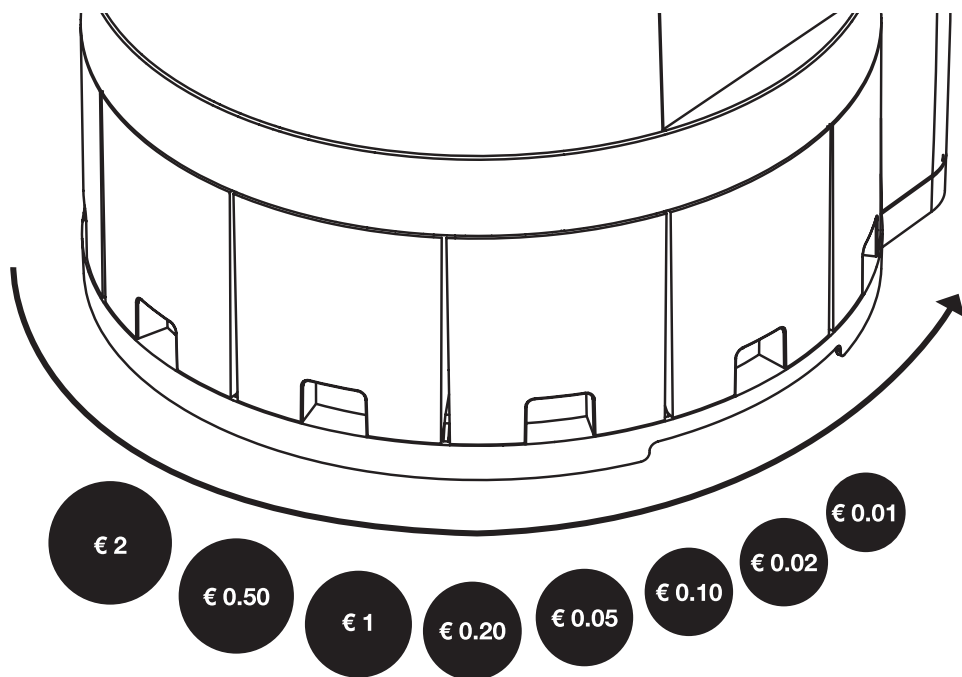

## View count result

Press **[REPORT]** to view the count result. The results are shown per denomination, starting with € 0,01. Repeatedly pressing **[REPORT]** will show the count result of the other denominations, in order of value (low to high). The report sequence is a loop:

0,01 - 0,02 - 0,05 - 0,10 - 0,20 - 0,50 - 1,00 - 2,00 - 0,01 - 0,02 etc.

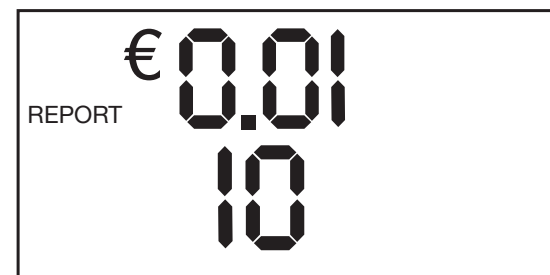

Result 1 Cent: 10 Coins  
Press **[START]** to return to the grand total.

## Batch counting

The batch function is used to create a fixed number of coins and can be set per denomination. In counting mode, press **[+]** to activate or deactivate batch counting. **BAT ON** will be shown on the display.



## Setting a batch number

To set a batch number:

1. Press **[SETTINGS]**.
2. In the display the default batch number of € 0,01 is shown.
3. Use **[+]** or **[-]** to adjust the batch number in steps of 1. Pressing and holding the **[+]** or **[-]** button increases or decreases the batch number by 10.
4. Press **[PRINT/>]** to switch to the next denomination.
5. Repeat step 3 and 4 until the batch number of all denominations has been set.
6. Press **[START]** to exit the batch settings menu.

**Note:** batch number 0 means no batch has been set.



No batch stop for 1 cent coin



Counting stops after 20 coins of 5 cents

If during counting the batch amount of a coin denomination is reached, the 1450 will stop. Press **[START]** to resume counting.

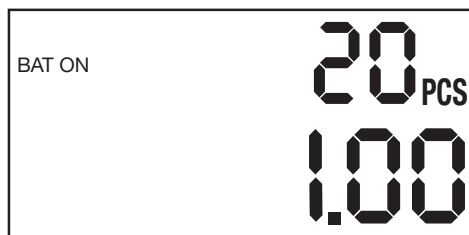

Counting stops at 20 pcs of 5 cent coins

## Deleting a batch number

Press the **[CLEAR]** button to delete the batch number of the selected denomination.

Press and hold the **[CLEAR]** button for approx. 2 seconds to clear all set batch amounts.

## Maximum number of coins per cup

To prevent overflow, the Safescan 1450 will stop automatically when the maximum number of coins per cup has been reached.

### Coin Denomination

### Maximum per cup

€ 0.01	400 Pieces
€ 0.02	250 Pieces
€ 0.05	200 Pieces
€ 0.10	200 Pieces
€ 0.20	140 Pieces
€ 0.50	100 Pieces
€ 1.00	120 Pieces
€ 2.00	100 Pieces

If, during counting, the maximum number of a coin denomination is reached, you receive the following message:

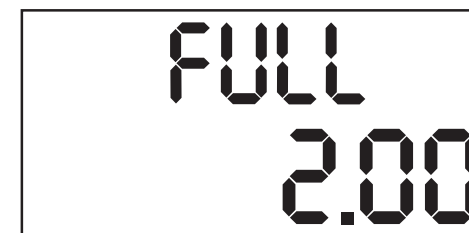

Maximum value reached at € 2.00. After removing the coins from the cup, you can continue counting by pressing **[START]**.

## Time and date settings

Press **[SETTING]** 2 times to set the date and time. The machine starts with the Year setting. Press **[+]** and **[-]** to adjust the value. Press **[PRINT/>]** to toggle between year (**Y**), month (**M**), day (**D**) and time.

1

DATE  
42018

2

DATE  
7 02

3

DATE  
0 18

4

TIME  
10:07

## Error codes overview

Error code	Cause of error	Solution
<b>ERR 1</b>	Infrared error Sensor 1 (1 Cent)	<
<b>ERR 2</b>	Infrared error Sensor 2 (2 Cent)	<<
<b>ERR 3</b>	Infrared error Sensor 3 (5 Cent)	Clean the corresponding IR sensor
<b>ERR 4</b>	Infrared error Sensor 4 (10 Cent)	If the error persists, please contact
<b>ERR 5</b>	Infrared error Sensor 5 (20 Cent)	Safescan support
<b>ERR 6</b>	Infrared error Sensor 6 (50 Cent)	>>>>
<b>ERR 7</b>	Infrared error Sensor 7 (1.00 Euro)	>>>
<b>ERR 8</b>	Infrared error Sensor 8 (2.00 Euro)	>>
<b>ERR 9</b>	Infrared error Hopper Sensor	>
<b>CLOSE HOPPER</b>	After the machine was opened, the safety lock switch may still be in the 'open' position	Slide the Safety-Lock switch to 'locked' position
<b>OLOAD1</b>	Something is stuck inside of the device and may be blocking its internal parts	Remove the object that is causing the blockage (see chapter: Removing a jammed item)



## Maintenance & servicing

Dust and dirt may block the sensors of the machine and could end up as well in the transport area of the coins. These dirt deposits may lead to problems during transport and sorting of the coins. To ensure reliable operation, the transport assembly and the sensors of the device need to be cleaned regularly.

### Before cleaning

**ALWAYS**, unplug the Safescan 1450 coin counter from the mains outlet.

### Removing the transport assembly

1. Slide the safety lock switch on the back to the 'open' position.
2. Grab the 2 hopper handles and pull them towards you.
3. Lift the cover from the device.
4. Press the transport assembly (the metal ring) downwards and keep it pressed while you rotate the ring to the center position (in between 1 and 2).  
**Note down if the ring was mounted in position 1 or 2.**
5. Lift the ring.

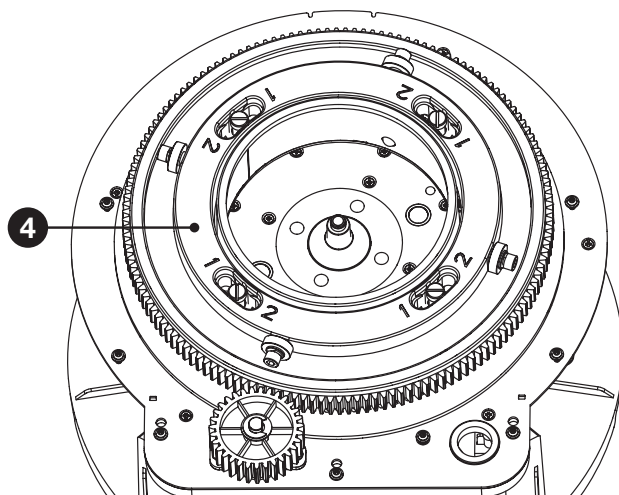

## Cleaning the coin transport area and sensors

Clean the coin sorting area, the transport assembly (including the black outer soft plastic ring) and sensors with the cleaning brush. Excess dust can best be removed with compressed air (available in a spray can for example). Before cleaning the sensors, remove the coin cups. Clean the sensors located inside the sorting holes. In addition, the transport rail should also be cleaned.

1. Clean the transport assembly with cleaning brush and/or compressed air

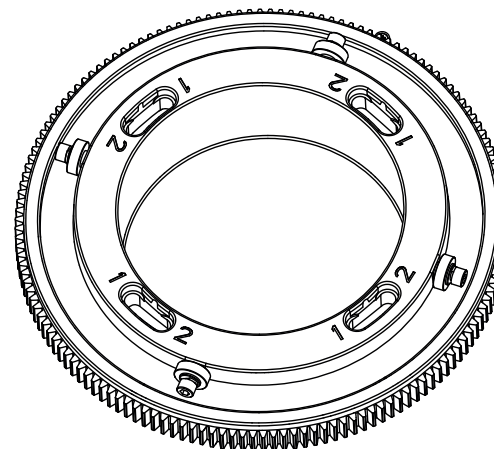

2. Clean the coin transport area

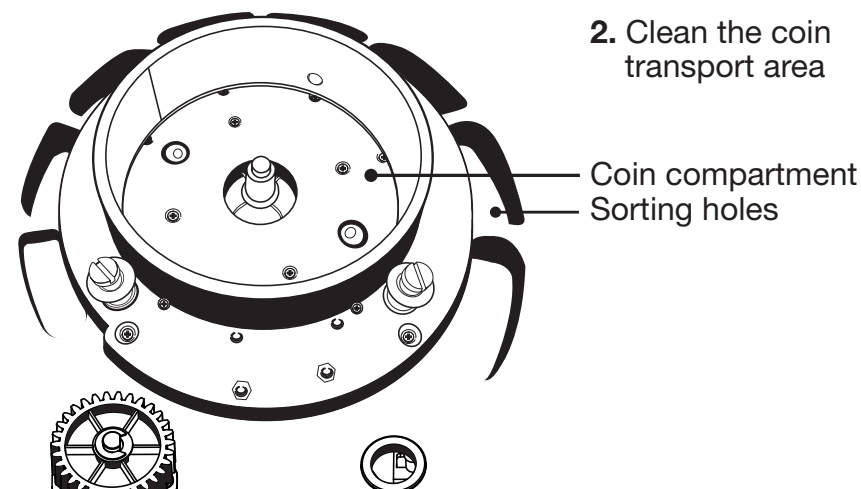

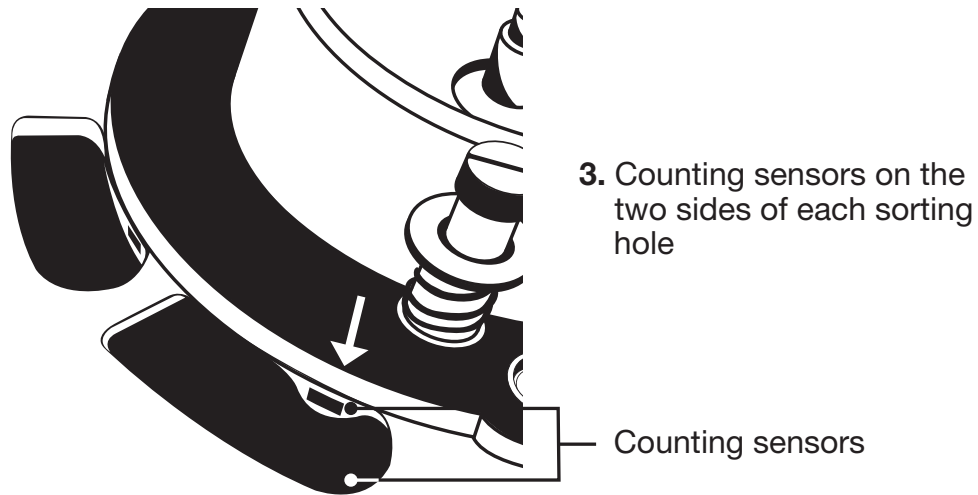

After cleaning, mount the transport assembly back to its original position (1 or 2). To do so, gently push and slide the assembly in its position. Place the cover back on the device and slide the safety-lock switch on the back to the 'locked' position. Place the coin cups back.

Connect the device to the mains outlet and switch it on.

## Removing a jammed item

Before you insert your coins, it is important to make sure that there are no foreign objects hidden in your batch. If a foreign object such as paperclips, different (currency) coins, or even larger amounts of dirt and dust, do end up in your device, they might get stuck and block its internal parts and sorting area. Whenever this happens, the device will show the error message "OLOAD1".

Please follow the instructions below to remove the jammed item.

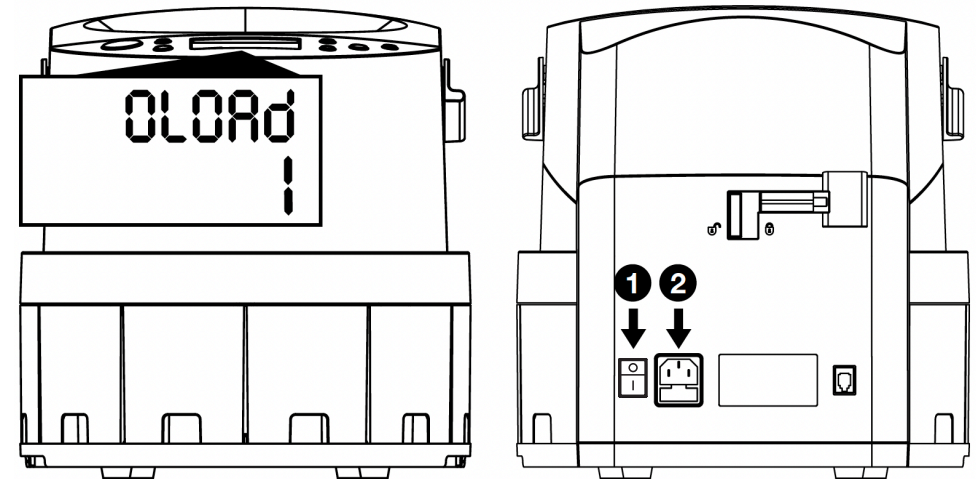

1. Error message OLOAD1 is shown.

2. Switch off the device (1) and remove the power cord (2).

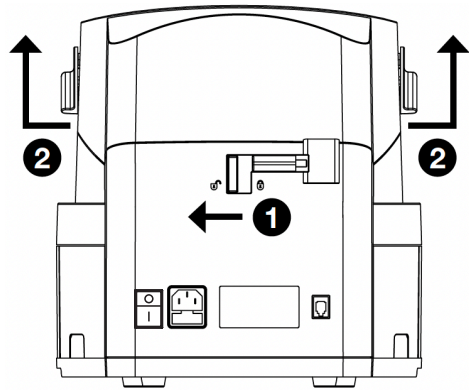

3. Remove the top cover by following the steps displayed in the image ( 1- 2 ).

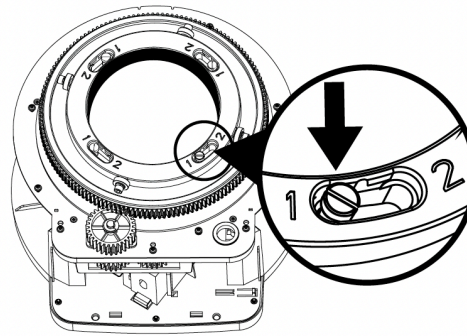

4. Check and note how the sorting ring is positioned (position 1 or 2) for later.

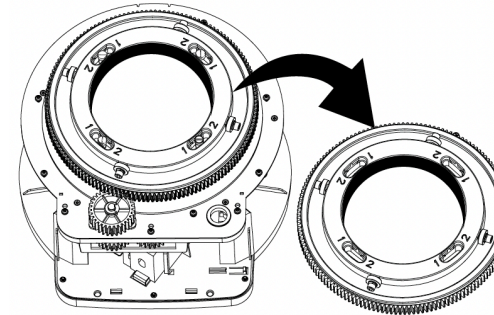

6. You can now remove the sorting ring.

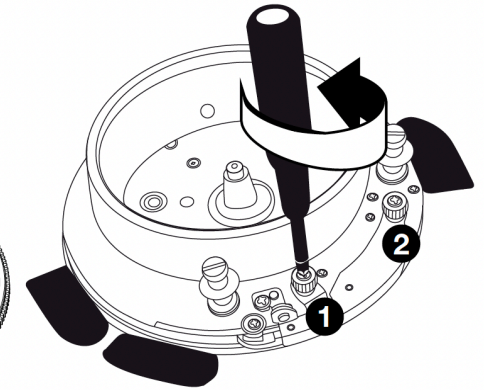

7. Use a screwdriver to remove the screws marked 1 and 2.

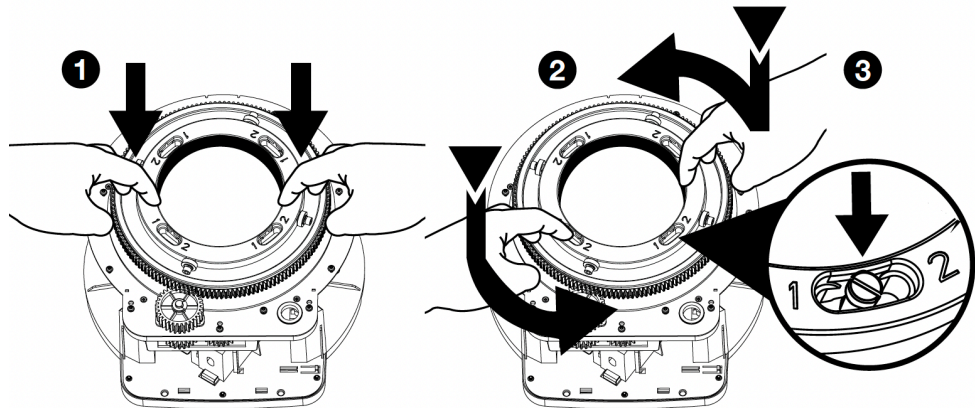

5. Remove the sorting ring by pushing it down (1) and turning it (2) until the screw is located in the middle (3).

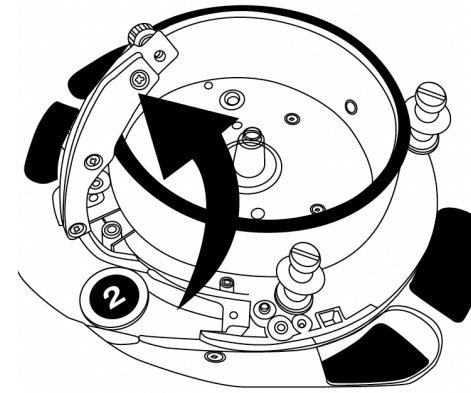

8. You can now mechanism to create space. Please note that the screws will stay attached to the metal mechanism.

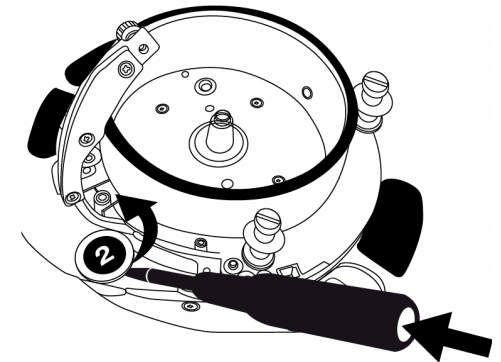

9. Carefully remove the jammed item.

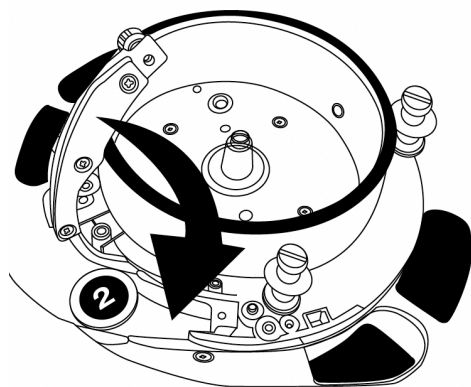

10. Once the item is removed, you can place the mechanism back.

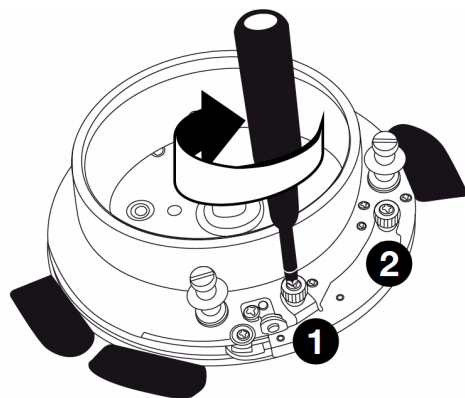

11. Use a screwdriver to secure the screws marked 1 and 2, back into place.

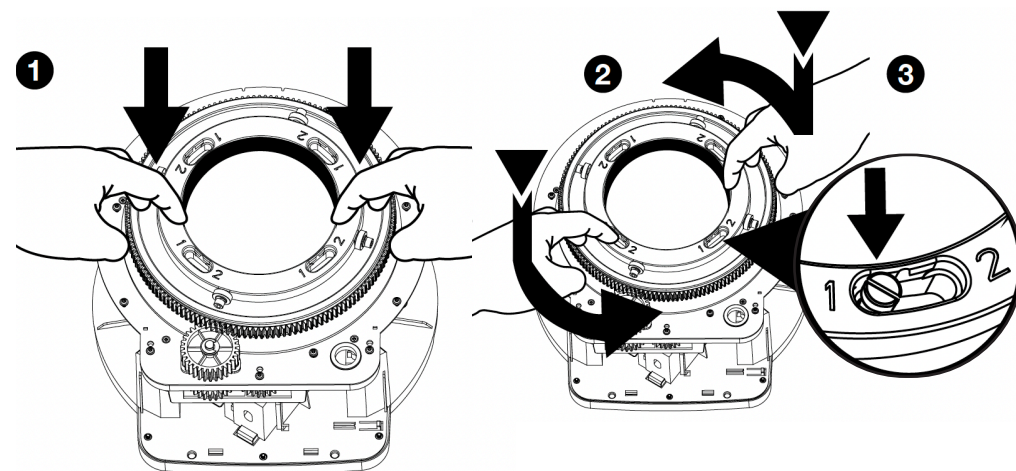

13. Put the ring back in its original position by pushing it down and turning it to the correct number.

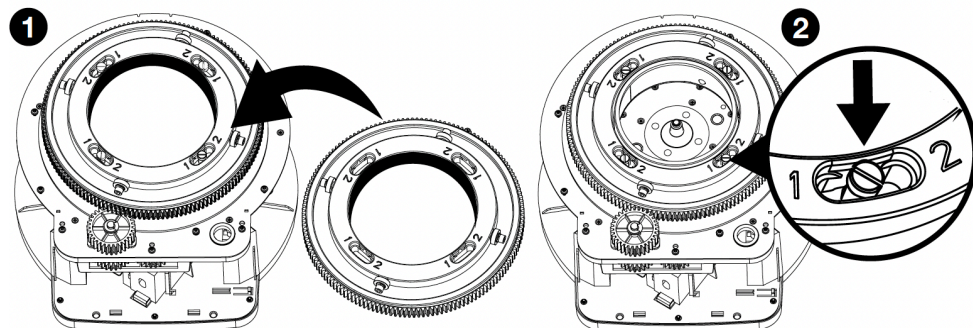

12. Place the sorting ring back in the device with the screw positioned in the middle.

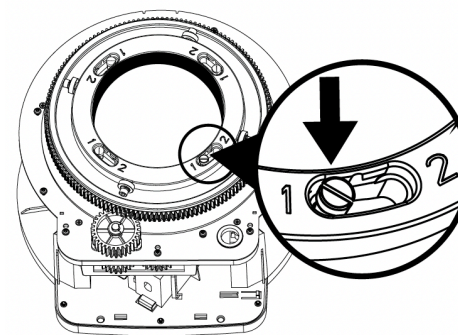

14. Double check if the screw is positioned correctly (1 or 2).

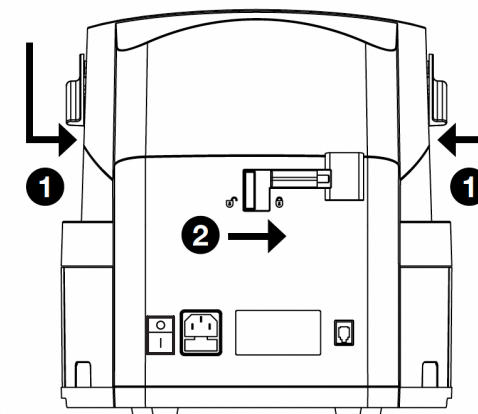

15. Place the top cover bank on the device by following the steps displayed in the image.

### Place note

Please note that the instructions above only apply to the Safescan 1450 models that have the serial number **112059919180001** or higher.

## Replacing the transport assembly

The transport assembly is designed to count max. 900.000 coins. After 400.000 coins have been counted the following message will appear on the display:

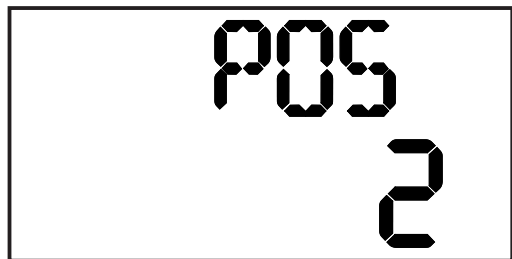

The transport assembly is by default placed in position **[1]**. The position number is indicated on the metal ring. When the above message appears, it must be switched to position **[2]**, in order to compensate for the abrasion caused by the transport of the coins.

Switch off the machine, open the machine cover as described in chapter **“Removing the transport assembly”**. Press the transport assembly down, then rotate the transport assembly clockwise to position **[2]**. Close the cover and switch on the machine. The above message will reappear on the display.

Confirm that the transport assembly is now in position **[2]** by pressing the **[REPORT]** and **[-]** keys.

You can also press the **[START]** button to bypass the **“POS 2”** message and start a counting process, but when you next time switch on the device, you will receive the above message again.

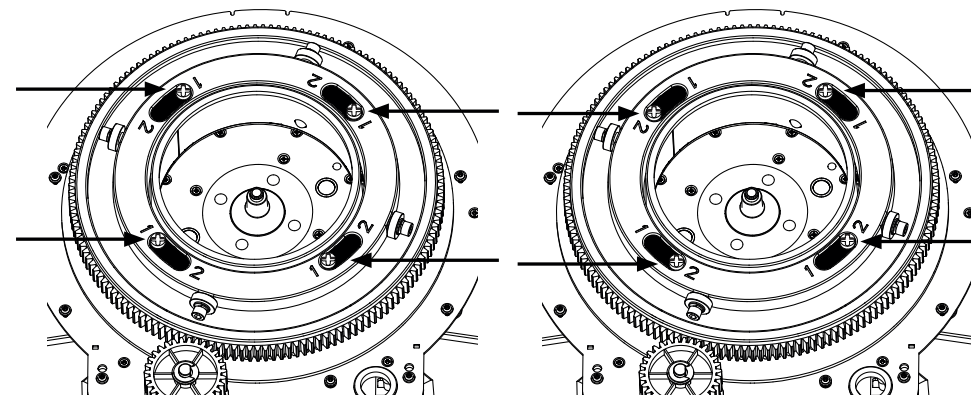

Position 1

Position 2

After 900.000 coins have been counted, the transport assembly needs to be replaced. The following message will appear:

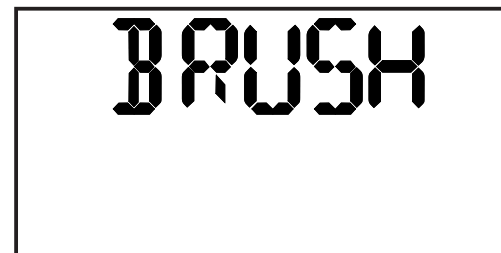

This indicates that the transport assembly needs to be replaced. The assembly can be ordered as sparepart from Safescan.

To change the transport assembly: Switch off the machine, open the machine as described in chapter **“Removing the transport assembly”**. Press the transport assembly down, then rotate the transport assembly to the middle position inbetween **[1]** and **[2]**.

Remove the used assembly. Mount the new transport assembly in position **[1]**. Reset the total coin count to zero after replacing the transport assembly by holding **[REPORT]** and **[-]** key and switching on the machine until the following message is displayed. Press the **[CLEAR]** button to reset the total coin count to **0**.

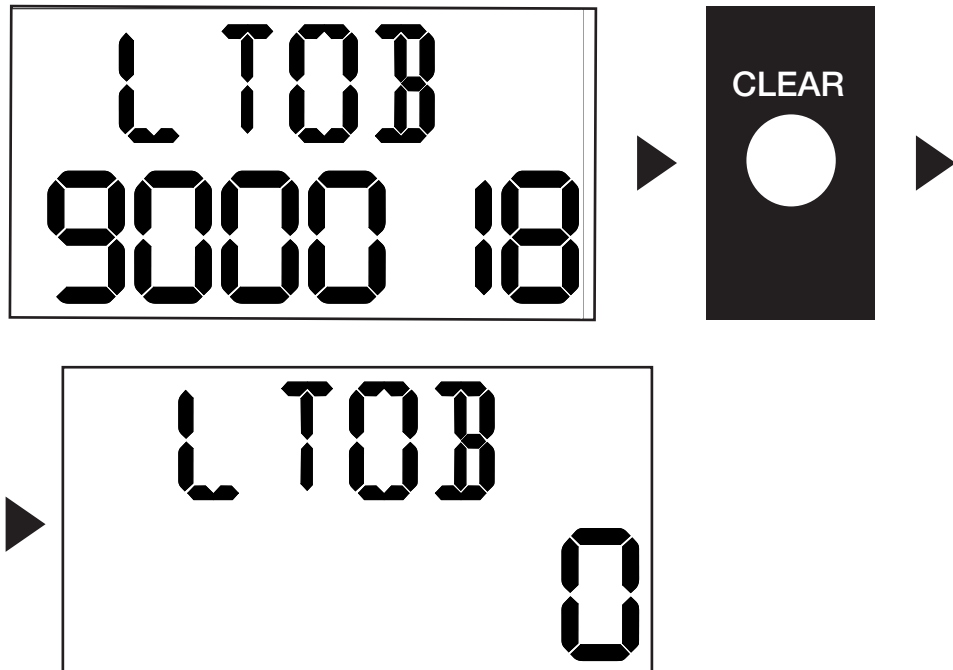

## Changing the fuse

The device is protected by a fuse, which can be easily replaced when required. Please turn off the machine before removing the fuse and unplug the power cord from the unit. Otherwise there is a risk of life due to electrical shock. Remove the fuse cover and replace the fuse with an equivalent fuse. The lock of the fuse must be firmly pressed again after changing.

## Use in combination with Safescan TP-230 printer

The Safescan 1450 can also be used in combination with the optional Safescan TP-230 thermal printer. This enables you to make an instant printout of your counting results.

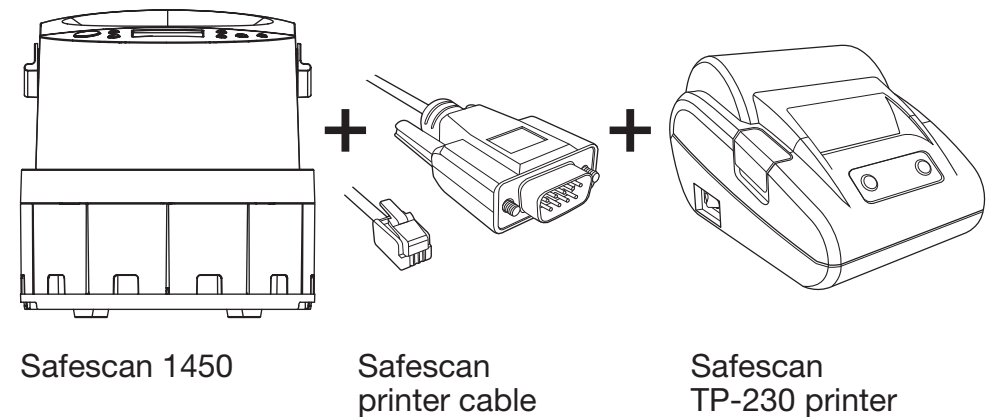

## Technical Specifications

---

Currency:	Euro
Counting speed:	500 coins per minute
Hopper capacity:	1000 coins
Coin cup capacity:	100-400 (depends on denomination)
Display:	LCD backlit
Printer port:	RJ10
Power connection:	100 - 240 V / 50 – 60 Hz
Power consumption:	max. 60 W
Operating temperature:	0°C – 40°C
Humidity:	30 - 75 %
Dimensions:	29 x 31 x 29 cm
Weight:	6.85 kg

**Safescan® is a registered trademark of Solid Control Holding B.V.**

No part of this manual may be reproduced in any form, by print, copy or in any other way without prior written permission of Solid Control Holding B.V. Solid Control Holding B.V. reserves all intellectual and industrial property rights such as any and all of their patent, trademark, design, manufacturing, reproduction, use and sales rights. All information in this manual is subject to change without prior notice. Solid Control Holding B.V. is not liable and/or responsible in any way for the information provided in this catalog. 20231

**Safescan®**

[www.safescan.com](http://www.safescan.com)  
info@safescan.com