

User Manual

English

155-S Counterfeit Detector

1. Package content

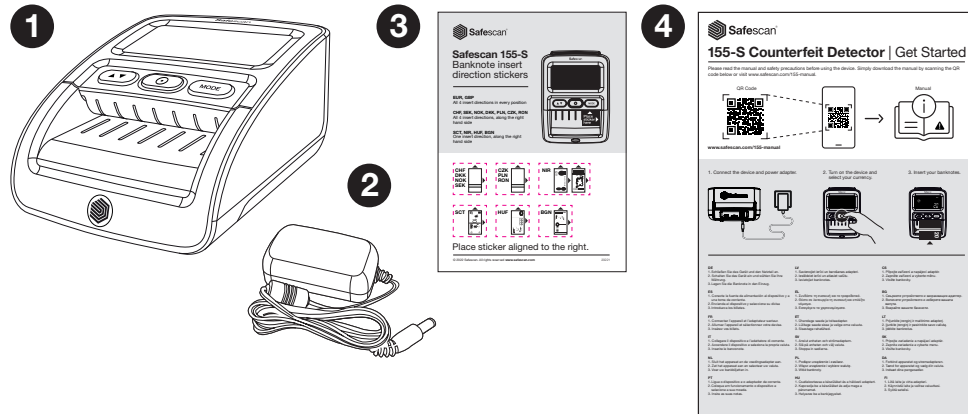

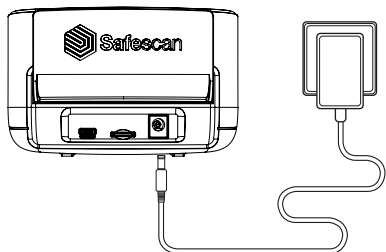

1. Safescan 155-S
2. Power adapter
3. Banknote insert direction sticker
4. Get started leaflet/Safety instructions

2. Power ON-Standby mode

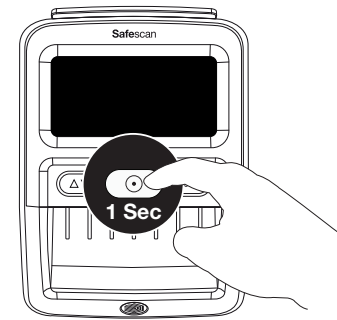

Connect the power adapter to the device and plug it into the mains outlet





Press the  key for approx. 1 second to power on the detector.

NOTE: When not in use, the display will go into standby mode after 30 seconds. The blue light remains on. Press  key 1x to activate. When a banknote is inserted, the detector will be activated automatically.

3. Set up your device

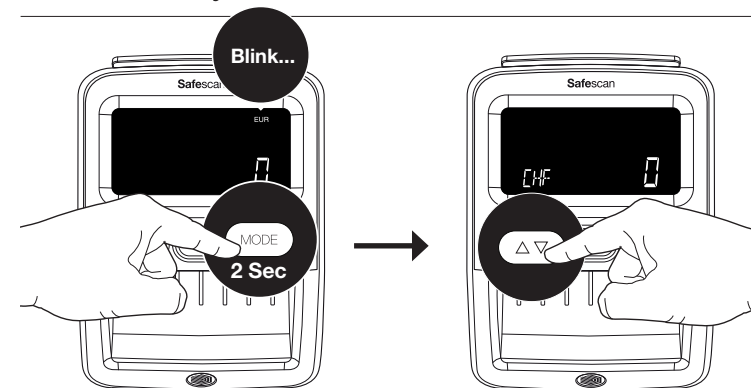
3.1. Currency selection



Select your currency by pressing the  key for 2 seconds. The currency indicator starts blinking. Press  repeatedly until you have reached the desired currency*. Wait for 2 seconds, the selected currency stops blinking to confirm selection.

NOTE: Currencies EUR and GBP are shown on the top right hand side of the screen, all other currencies are shown in the bottom left corner.

3.2. Banknote exit direction

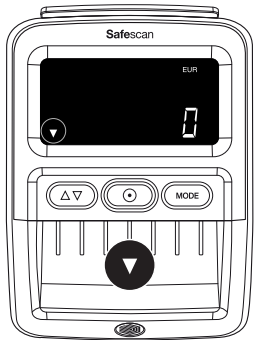

1

Default: Banknote exit at front. Set your banknote exit direction by pressing the  key for 2 seconds.

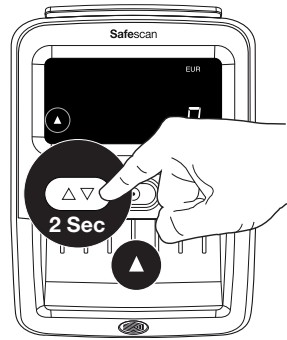

2

Banknote exit at rear.

Note: It is recommended to remove the banknote exit guide if banknote exit at rear is selected. To remove the banknote guide. See chapter 5.

Note 2: Exit at the rear works best with the optional RS-100 banknote stacker. RS-100 Article 112-0695, See safescan.com for more details.

4. Display and controls

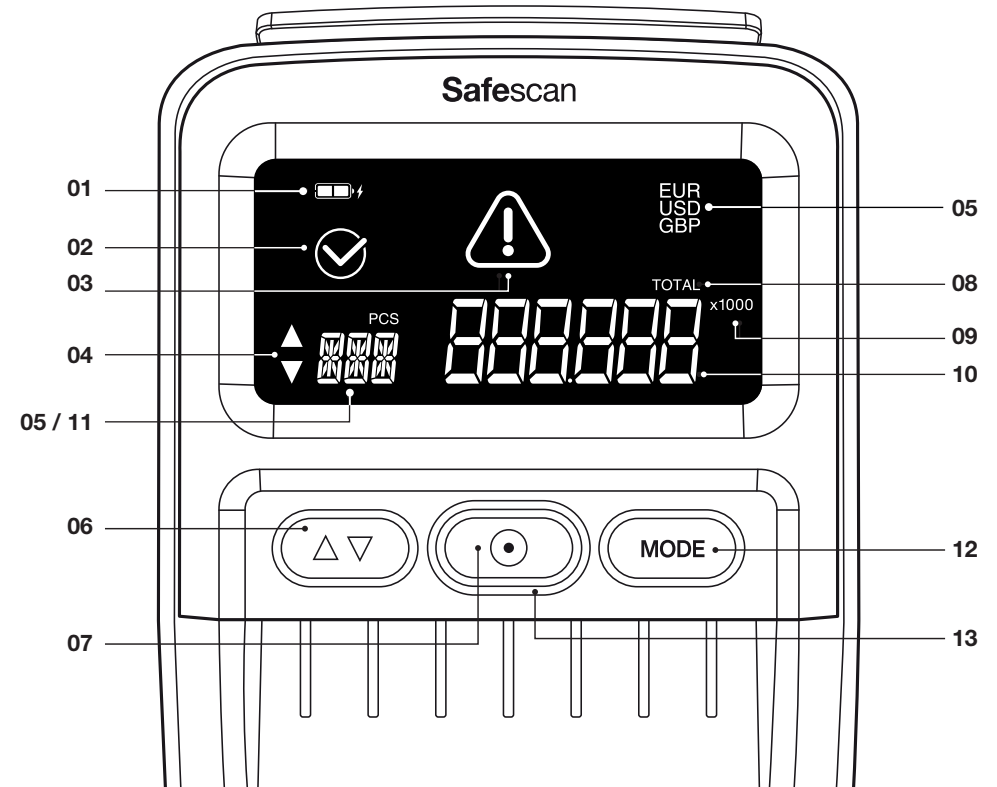

- 01. Battery status indicator (when battery is inserted)
- 02. Correct detected banknote icon
- 03. Error message icon
- 04. Banknote exit direction indicator
- 05. Activated currency
- 06. Long press: Banknote exit direction selection
Short press: In currency selection mode: Toggle through currencies. In Add mode: Shows counting results
- 07. Long press: ON/OFF
Short press: In Add mode: Clear count results, In sleep: Activate operation mode

- 08. Total indicates ADD function is activated
- 09. Indication x100/1000: For large denomination values of specific currencies
- 10. Total value of scanned banknotes (in ADD mode only).
Denomination of last scanned banknote (in Denomination mode only)
- 11. Total number of scanned banknotes (in ADD mode only)
- 12. Long press: Open currency selection mode
Short press: Change operation mode
- 13. Blue light: ON/Standby. Red light: Error

5. Operating instructions

5.1. Inserting banknotes

Banknotes need to be inserted in the correct manner to successfully scan the security features. All banknotes need to be inserted straight and in the correct insert direction(s). Currencies EUR & GBP can be inserted in all positions (left - mid - right). All other currencies must be inserted along the right-hand side.

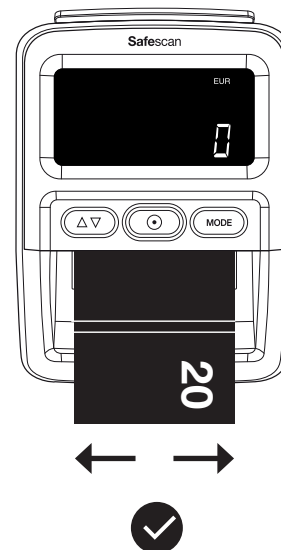

EUR GBP
- All 4 insert directions
- Any position

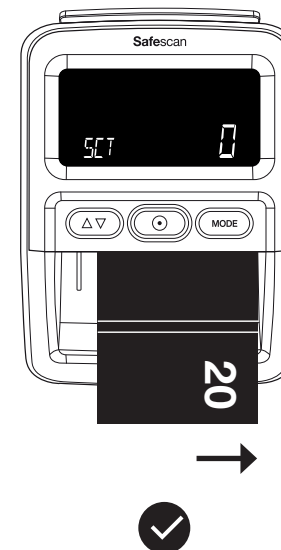

**CHF SEK NOK
DKK PLN CZK
RON**
- All 4 insert directions
- Along the right hand side

**SCT NIR HUF
BGN**
- Insert direction 1
- Along right hand side

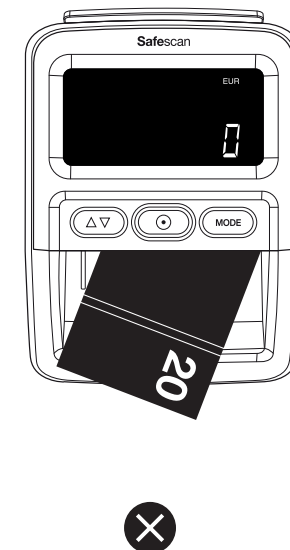

Avoid inserting banknotes at an angle, this will lead to errors and jams.

Insert directions

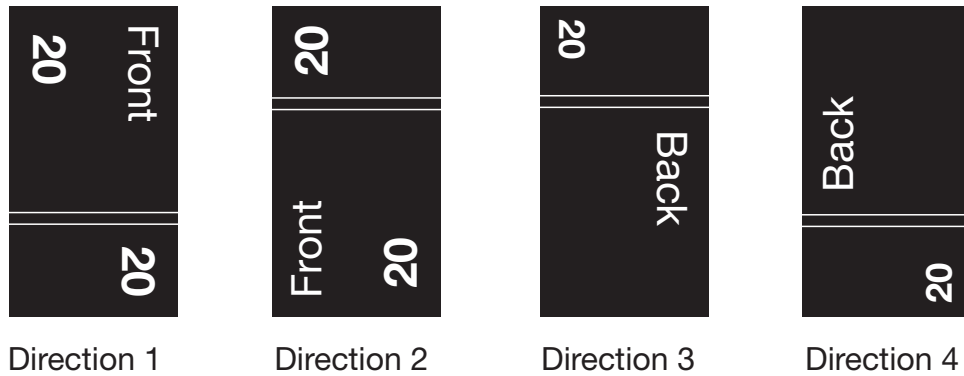

Note: You can use the included banknote insert sticker to align currencies other than EUR and GBP.

5.2. Detection modes

The Safescan 155-S has 2 detection modes:

Denomination mode: Showing the value of the last verified denomination on the screen.

Add mode: Showing the number and value of verified banknotes.
By pressing the  key you can switch

Press  to toggle between Denomination and Add mode.

5.3. Detection modes display information

Denomination mode

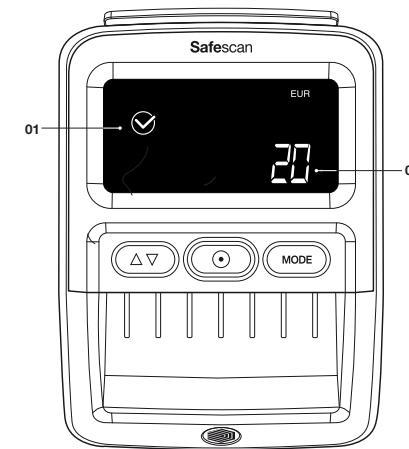

- 01. Correctly verified banknote icon
- 02. Denomination of last verified banknote

The denomination value will be shown for 2 seconds, before changing back to 0.

Add mode

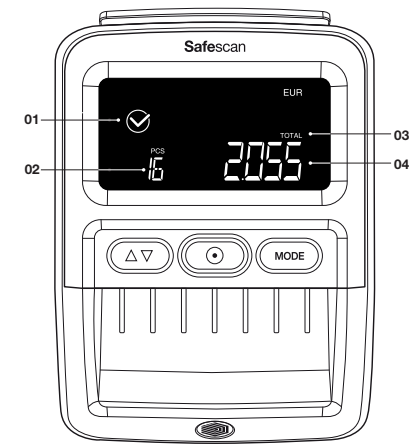

- 01. Correctly verified banknote icon
- 02. Total number of verified banknotes
- 03. Total indicates that the ADD function is activated
- 04. Total value of verified banknotes

After 30 seconds, the display will go into standby mode. The count result will be stored until the power is turned off.



When a suspected banknote is detected, a red light will blink  and a beep sounds 3 times. An error code will be displayed. For error messages, please refer to chapter 7.

5.4. Check counting results

In ADD mode, it is possible to view the counting results per denomination.

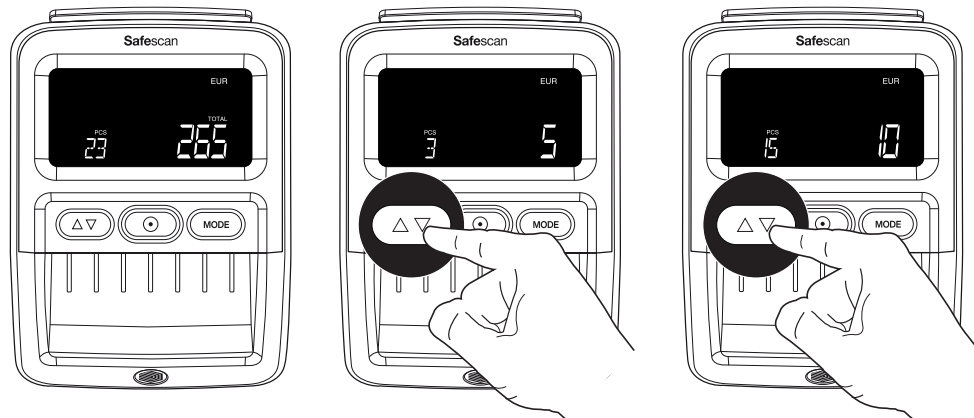

Press  button to see the results per counted denomination. A double beep will be heard when the results of all denominations have been shown.

NOTE: Only available in ADD mode.

5.5. Clear counting results

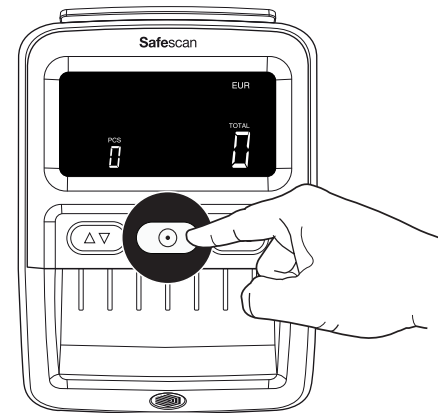

Press  key once to clear the counting results.

5.6. Counterfeit alarm sound OFF & ON

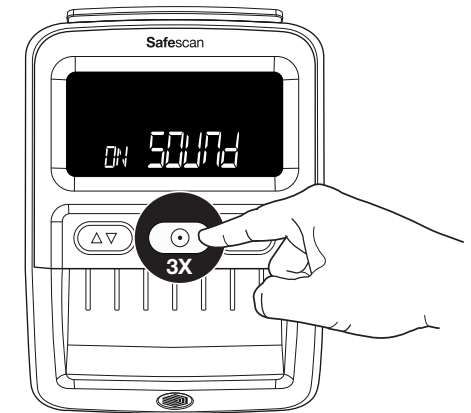

Press  key 3 times to switch all sounds Off/On including the counterfeit alarm.

6. Removing the banknote exit guide

The banknote exit guide is assembled on the 155-S by default as this part will allow the device to have the smallest possible footprint. In case you want to use the detector for counting larger amounts of banknotes it is better to remove the banknote exit guide to allow banknotes to exit from the backside (as described in chapter 3.2) The banknote exit guide can be removed by simply pull it out the attachment from the backside in 2 steps.

1. Hold on to the sides of the banknote exit guide.
2. Pull out the part horizontally until it comes loose.
3. The banknote exit guide can be placed back by simply pushing it back into the slots.

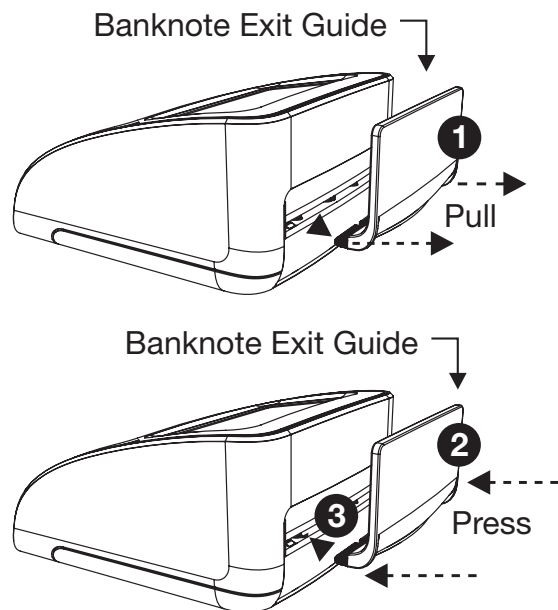

7. Error codes

E01	Banknote length error
E02/E03	Magnetic ink properties error
E04/E05	Infrared properties error
E06	Banknote thickness error / Double banknote error
E07	Slant banknote (banknote was not inserted straight)
E08	Metallic thread / security strip error
E09/E10/E11/E12	Infrared error
E14/E22	Colour error
E20	Passing error / Banknote insert error / Lid is open or not closed correctly
E24	UV error

NOTE: If error codes starting with A or P occur during Power On, then please contact Safescan Customer Success Team: www.safescan.com/contact

8. Cleaning instructions

1 Power off

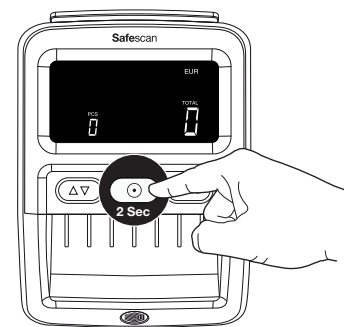

2 Unplug

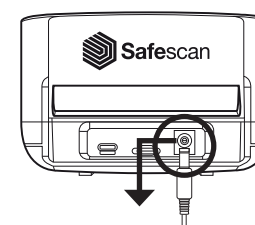

3 Open

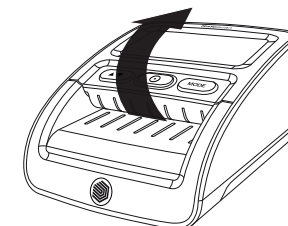

4

Clean the transport mechanism, magnetic heads and sensors with a dry cloth or cotton swab/ q-tip.

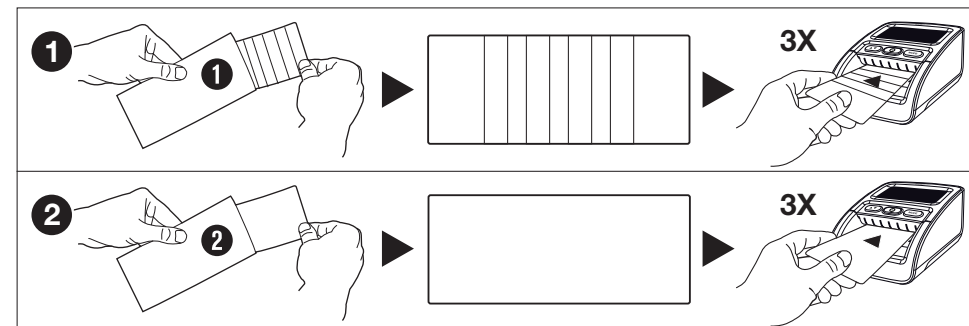
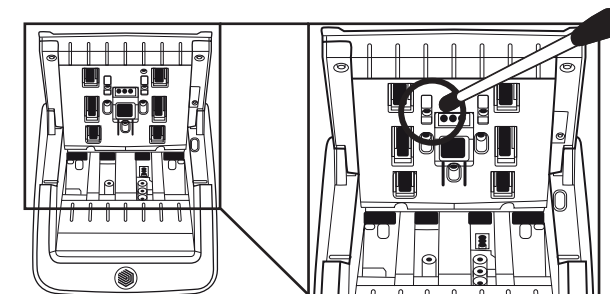

Cleaning cards (optional) You can also use the Safescan counterfeit detector cleaning cards (partno. 136-0545) to clean the roller wheels and magnetic sensors.

9. Currency updates

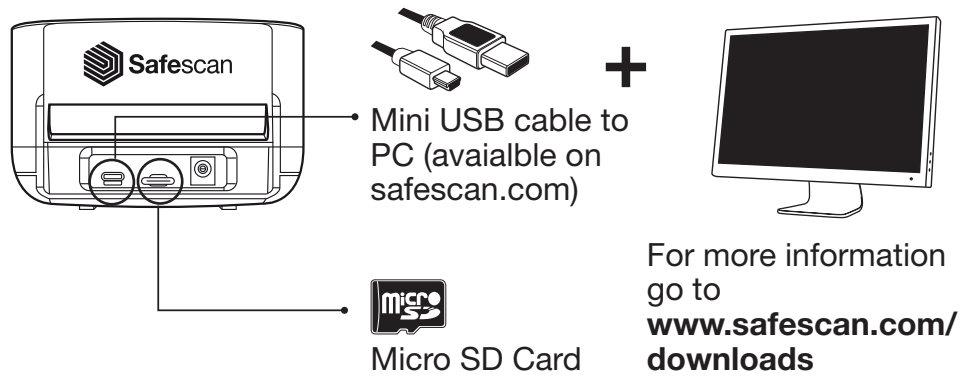

10. Accessories

10.1. Safescan LB-105 Rechargeable Battery

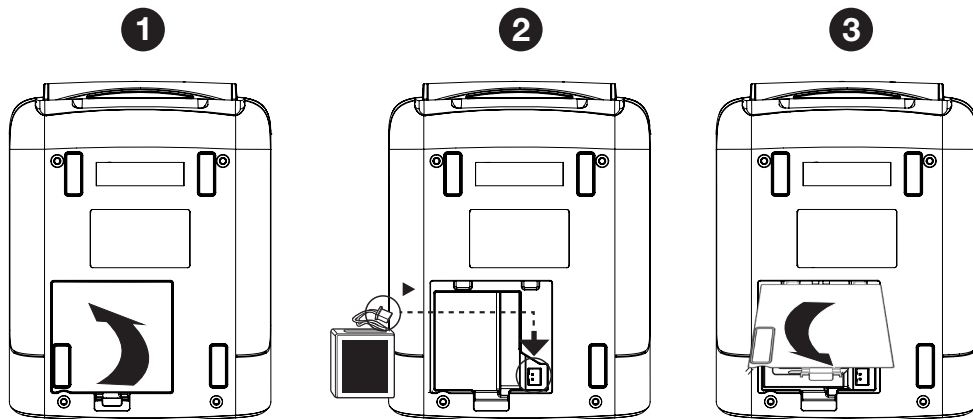

10.2. Detection modes display information

The battery status is shown in the first 5 seconds during the start-up of the device.

Adapter connected

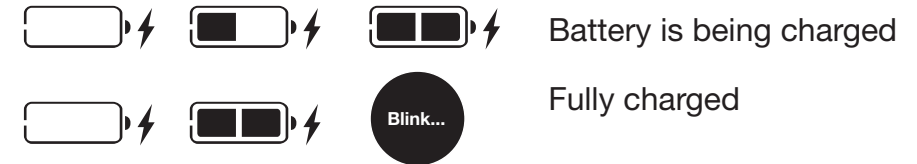

On battery

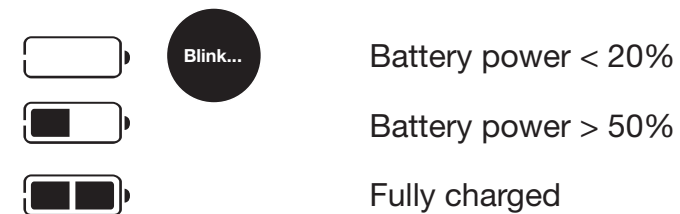

10.3. Banknote stacker

For the Safescan 155-S, an optional banknote stacker accessory is available: Safescan RS-100. This stacker can be used to detect, count and stack banknotes at the same time. The banknotes will be neatly stored in the stacker until you can take out the complete stack at once after the count. The stacker can contain up to 20 banknotes.

1. Remove the banknote exit guide from the device.

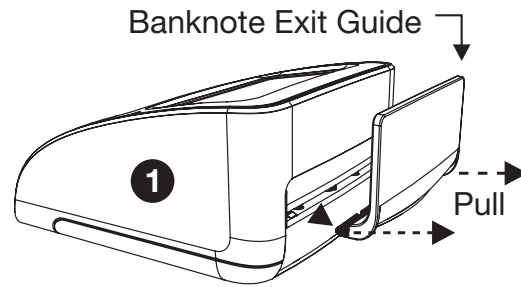

2. Hold the stacker with the in place at the back of the device with the 'teeth' facing forward and horizontally.

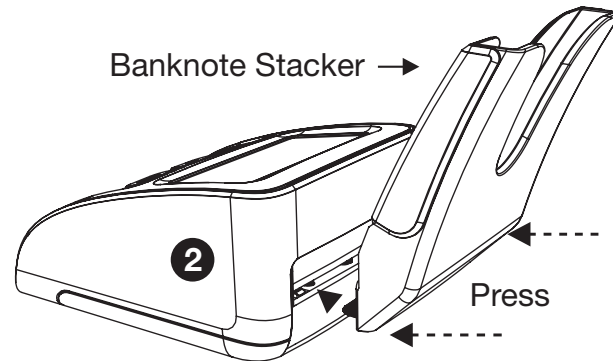

3. Push the stacker in to the slot. The stacker is ready to use.

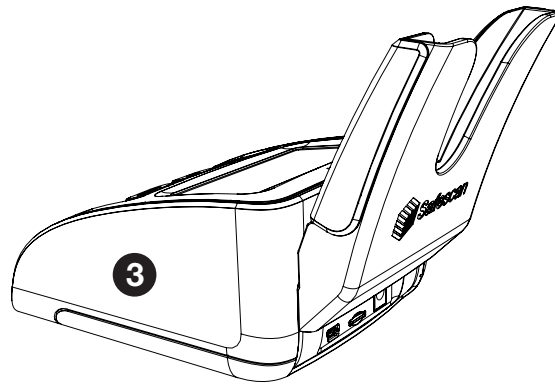

11. Safety precautions

Safescan 155-S

WARNING! Burns, electrical shock and fire hazard due to short-circuiting. Risk of serious injury



- Never use a damaged power adapter/power cord.
- Always use only the supplied power adapter.
- Never subject the device, power adapter or power cord to liquids or moisture.
- Never touch and (dis)connect the power adapter with wet hands.
- Always unplug the device from the mains socket if you want to move it to another position.
- Always hold the plug when unplugging the device from the mains socket, never pull the cord .
- Never spill any liquids or chemical (cleaning) detergents on the device.
- If liquid are spilled on the device, always disconnect the power from the mains supply socket, remove the battery (when installed) and contact Safescan for assistance.

CAUTION! Damage



- To avoid leakage. Remove the battery from the device in case of long term non-use or storage.
- This machine contains rotating parts. Never touch the moving parts when the machine is switched ON.
- Please ensure that no foreign objects (coins, paper clips, staples,) fall into the machine, these may block the mechanical parts and the sensors of the machine and damage or break them and will void your warranty.

NOTICE! Risk of damaging the device



- Make sure that no foreign object enters the device.
- Never disassemble the device.
- Do not use the machine in dusty or dirty environments, as this will lead to sensor malfunctioning.
- If the machine is not used for a long period of time, remove the power plug from the wall outlet, to avoid possible damage of the equipment.

BATTERY LB-105 (optional accessory)

WARNING! Burns, fire hazard and poisoning. Risk of serious injury



- Keep the battery away from fire, heat and water
- Always avoid touching the battery with your bare hands when battery is corroded or when leakage has occurred.

CAUTION! Damage, pollution



- To avoid leakage. Remove the battery from the device in case of long term non-use or storage.
- To avoid pollution. Dispose of batteries in accordance with local regulations.

12. Specifications

Supported currencies:	EUR, GBP, CHF, SEK, NOK, DKK, PLN, CZK, RON, SCT, NIR, HUF, BGN Depending on the installed currency pack. See www.safescan.com for availability)
Counting modes:	Denomination mode Add mode (Count mode)
Detecting speed:	1 second
Banknote feature detection:	MG, MT, IR, Colour, Paper Quality, Watermark, Length, Thickness,
Power adapter:	12V, 12 Watt, 1A
Mains Operating Voltage:	100-240V - 50/60Hz 0.4A Max
Power consumption:	Less than 10 Watts
Dimensions (W x D x H):	120 x 156 x 76 cm

Safescan® is a registered trademark of Solid Control Holding B.V.

No part of this manual may be reproduced in any form, by print, copy or in any other way without prior written permission of Solid Control Holding B.V. Solid Control Holding B.V. reserves all intellectual and industrial property rights such as any and all of their patent, trademark, design, manufacturing, reproduction, use and sales rights. All information in this manual is subject to change without prior notice. Solid Control Holding B.V. is not liable and/or responsible in any way for the information provided in this catalog. [221](#)

Safescan®

www.safescan.com
info@safescan.com